



A&P PLAZA

DOWNTOWN RETAIL OPPORTUNITY

Anderson, South Carolina



John Wright, Jr., CCIM
864.224.3503
johnjr@mccoywright.com

PROJECT OVERVIEW

Sitting as the north gateway into Downtown Anderson, the A&P Plaza offers great opportunity for a variety of tenants. The building offers retail space available from 1000-1400 square feet. It is directly adjacent to the newly completed Pedestrian Plaza and Magnetic South Brewery providing built in amenities for customers to enjoy!



John Wright, Jr., CCIM

864.224.3503 • johnjr@mccoyswright.com



McCoy Wright
COMMERCIAL REAL ESTATE

PROJECT RENDERINGS



John Wright, Jr., CCIM
864.224.3503 • johnjr@mccoywright.com

PROJECT SITE PLAN

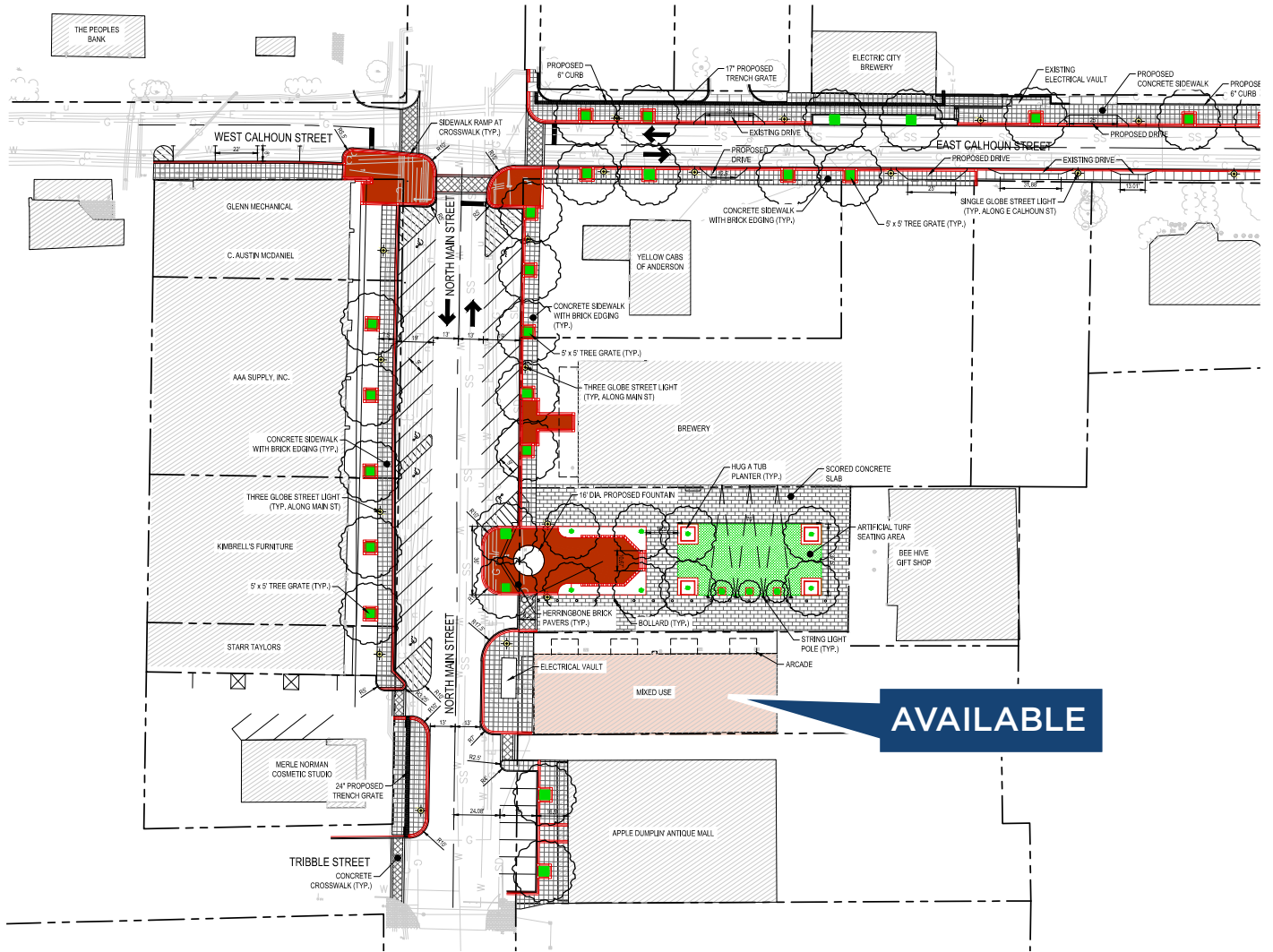

AVAILABLE SPACE

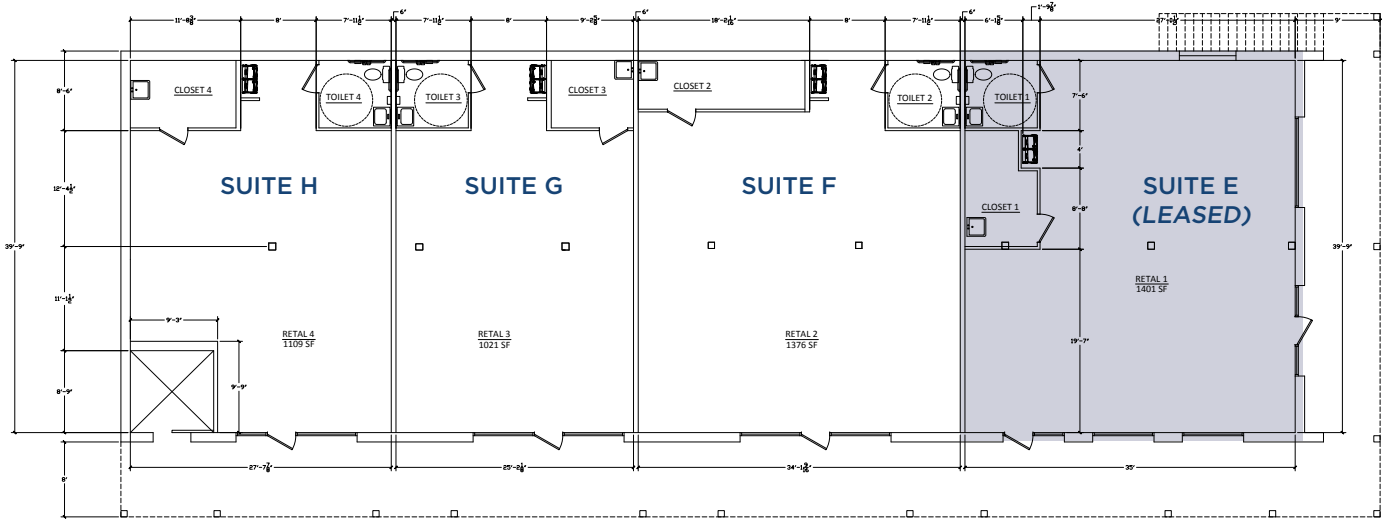

Upper Level

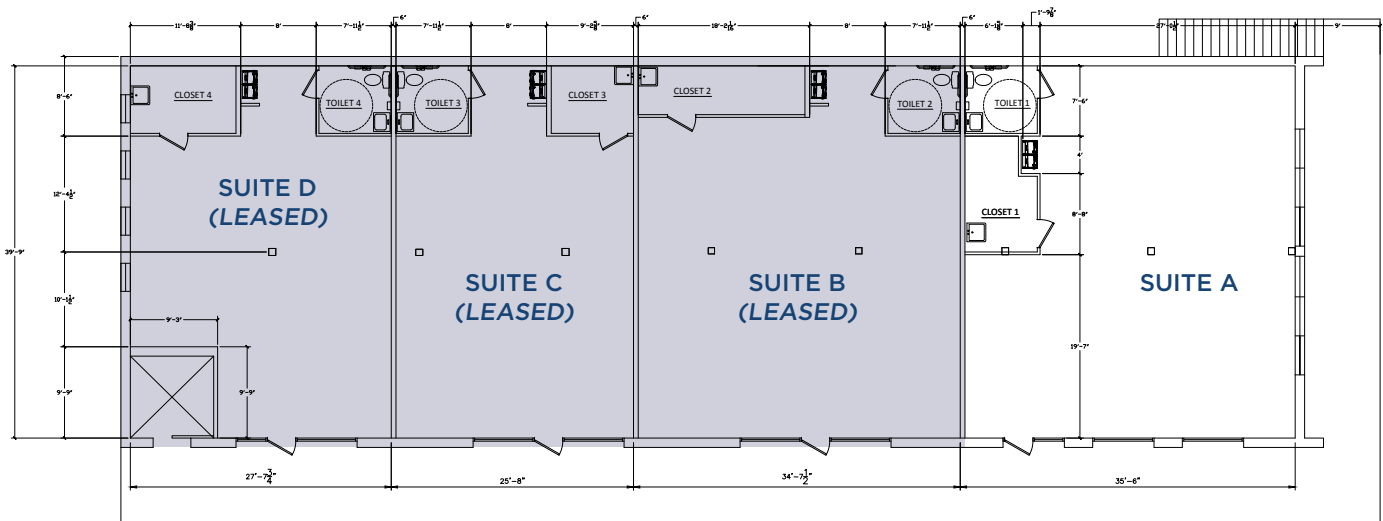

Lower Level

John Wright, Jr., CCIM

864.224.3503 • johnjr@mccoywright.com



McCOY WRIGHT
COMMERCIAL REAL ESTATE



John Wright, Jr., CCIM
864.224.3503 • johnjr@mccoywright.com

LOCATION

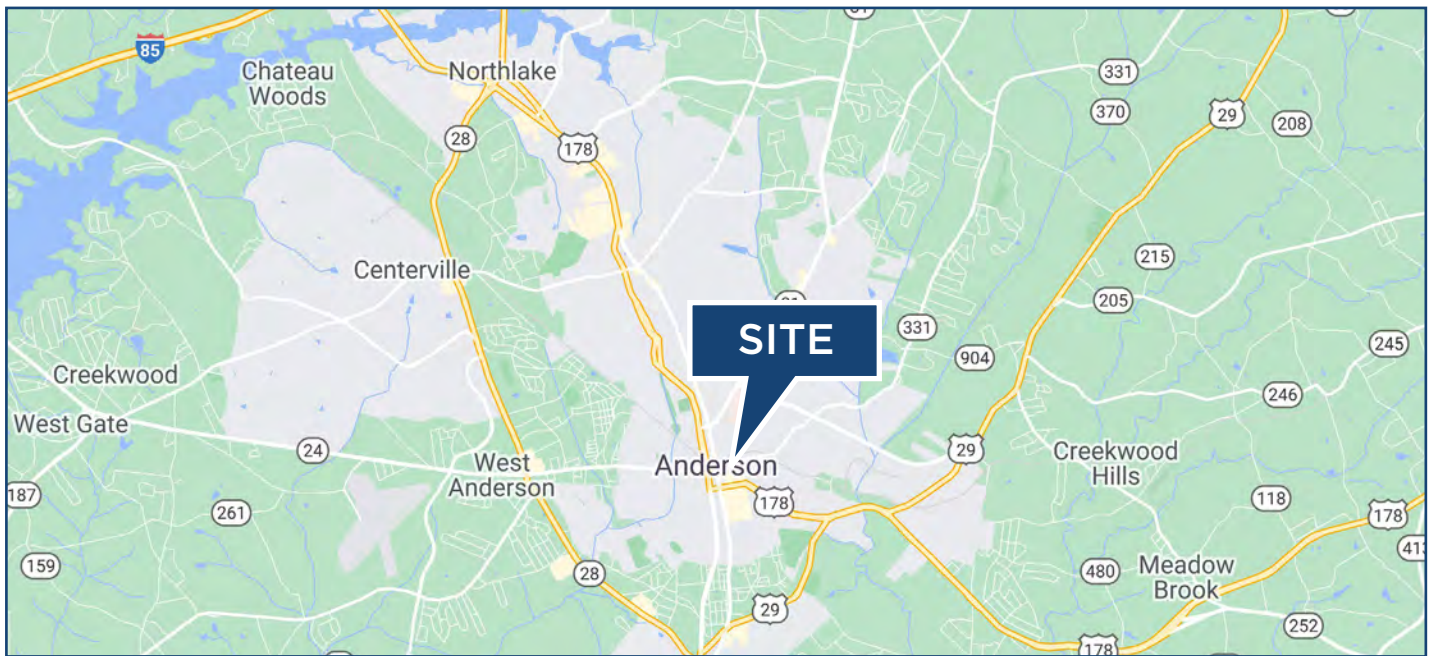

John Wright, Jr., CCIM
864.224.3503 • johnjr@mccoyswright.com

MARKET OVERVIEW



Anderson County

Anderson County lies along I-85 in the northwestern portion of Upstate South Carolina, equidistant to Atlanta, GA and Charlotte, NC. The area, with one of the lowest costs of living in the United States, is a thriving industrial, commercial, and tourist center. With more than 15 universities and colleges within 50 miles of Anderson, there are many great higher education options for students. With all of these, Anderson County has the integrated resources available to help train and develop a highly skilled workforce with the prestigious education and training programs of institutions including Anderson University, Clemson University, and Tri-County Technical College. Anderson County is also home to 55,950-acre Lake Hartwell, a U.S. Army Corps of Engineers lake with nearly 1,000 miles of shoreline for residential and recreational use. Its communities have a small-town feel that make people want to stay. From a temperate southern climate and Lake Hartwell, to leading universities and a variety of arts programs, Anderson County offers an unmatched combination of quality of life features that makes for an ideal location for all of its citizens.

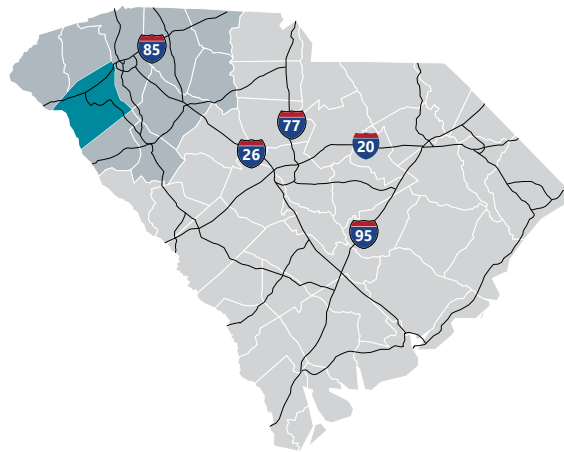

Total Population

	2010	2020	2025	Growth Rate ¹
Anderson County	187,126	208,587	219,541	1.03%
Upstate SC	1,362,073	1,534,241	1,622,166	1.12%
South Carolina	4,625,364	5,282,232	5,629,430	1.28%

¹Projected Annual Growth Rate 2020-2025

John Wright, Jr., CCIM

864.224.3503 • johnjr@mccoywright.com



McCOY WRIGHT
COMMERCIAL REAL ESTATE



MARKET OVERVIEW (Cont.)

Population by Age

	2010	2020	2025
Under 5	6.5%	5.8%	5.6%
5 to 9	6.6%	6.1%	5.9%
10 to 14	6.9%	6.2%	6.4%
15 to 24	12.5%	11.4%	11.1%
25 to 34	11.5%	12.4%	11.3%
35 to 44	13.3%	12.0%	12.4%
45 to 54	14.8%	13.2%	12.6%
55 to 64	12.9%	14.2%	13.7%
65+	15.1%	18.8%	21.1%
Median Age	39.7	41.7	42.8

37.6% of the of 2020 population is prime working age

Population by Race & Ethnicity

	2010	2020	2025
White	80.1%	79.7%	79.3%
Black	16.0%	15.2%	14.8%
American Indian/ Alaska Native	0.3%	0.3%	0.3%
Asian	0.8%	1.0%	1.2%
Hawaiian/ Pacific Islander	0.0%	0.0%	0.0%
Some Other Race	1.3%	1.8%	2.1%
Two or More Races	1.5%	2.0%	2.3%
Hispanic Origin (Any Race)	2.9%	4.1%	4.9%

Households & Families

	2010	2020	2025
Total Households	73,829	81,961	86,200
Total Families	51,922	56,666	59,284
Average HH Size	2.50	2.51	2.51
Renter Occupied*	24.6%	25.3%	25.3%
Owner Occupied*	62.5%	62.9%	63.1%

*Housing tenure data is a percentage of total occupied housing units

Median Household Income

	2020	2025
Anderson County	\$52,904	\$56,092
South Carolina	\$53,366	\$56,881
United States	\$62,203	\$67,325

Per Capita Income

	2020	2025
Anderson County	\$52,904	\$56,092
South Carolina	\$53,366	\$56,881
United States	\$62,203	\$67,325

2020 Highest Education Attainment, Age 25+

High School Diploma or Higher



Bachelor's Degree or Higher

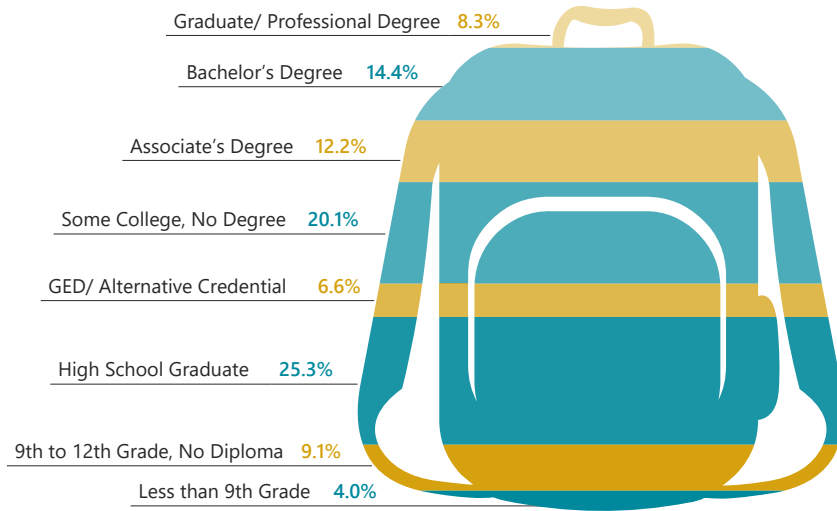

John Wright, Jr., CCIM

864.224.3503 • johnjr@mccoyswright.com



McCOY WRIGHT
COMMERCIAL REAL ESTATE



MARKET OVERVIEW (Cont.)



2018 Commuting Patterns

Travel Distance to Work

Less than 10 miles	38.5%
10-24 miles	30.7%
25-50 miles	17.0%
50 miles or more	13.8%

69.2% of workers travel less than 25 miles

Worker Inflow/Outflow

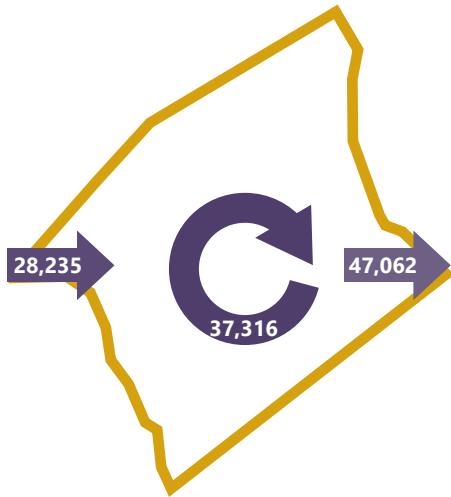

Live and Work in Anderson County	37,316
Commute into Anderson County	28,235
Commute Out of Anderson County	47,062

Where Do Anderson County Workers Live?

Anderson County	56.9%
Greenville County	11.3%
Pickens County	7.3%
Oconee County	3.9%
Spartanburg County	2.8%
Abbeville County	2.3%
Laurens County	1.3%
Greenwood County	1.3%
Richland County	1.1%
Lexington County	0.8%

2020 Employment by Industry

Agriculture/Mining	0.6%	487
Construction	6.4%	5,613
Manufacturing	22.1%	19,254
Wholesale Trade	2.7%	2,391
Retail Trade	10.6%	9,266
Transportation/Utilities	4.1%	3,541
Information	1.0%	885
Finance/Insurance/Real Estate	4.5%	3,929
Services	45.1%	39,335
Public Administration	3.0%	2,611
Total	100%	87,312

2020 Civilian Population in Labor Force (16+)

Labor Force	90.1%
Unemployed	9.9%

Gross Retail Sales by Fiscal Year

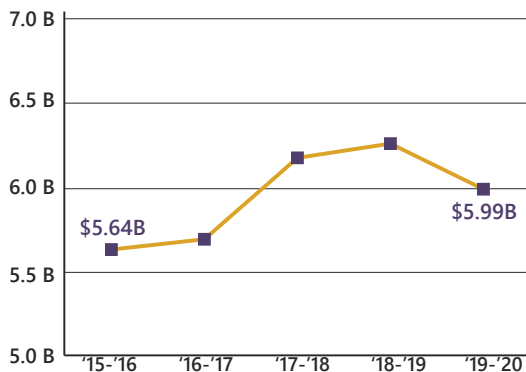

2020 Business Establishments by Industry



John Wright, Jr., CCIM

864.224.3503 • johnjr@mccoyswright.com



McCOY WRIGHT
COMMERCIAL REAL ESTATE







MARKET OVERVIEW (Cont.)

Top 5 Manufacturing Employers

Company	Employees	Primary Product(s)
Electrolux Home Products	1,950	Home appliances
Robert Bosch	1,431	Automotive components
Michelin North America	1,365	Rubber tires
Techtronic Industries (TTI)	1,100	Power equipment and tools
First Quality Enterprises	800	Paper and tissue products

Top 5 Non-Manufacturing Employers

Company	Employees	Industry
Anderson County Public Schools	4,184	Public Schools, K-12
AnMed Health	3,777	Healthcare
Anderson County	1,118	Local Government
Tri-County Technical College	856	Higher Education
Anderson University	674	Higher Education

 <p>Airport Access</p> <p>Greenville Spartanburg International</p> <ul style="list-style-type: none"> - 50 non-stop daily departures - 17 major cities and airports across the US - Allegiant Air - American Airlines - Delta - Southwest Airlines - United Airlines - 2.6 M passengers served in 2019 - 57,304 tons of air cargo moved in 2019 <p>Anderson Regional Airport</p> <ul style="list-style-type: none"> - 6,001 ft runway - Category 1 Instrument Landing System 	 <p>Port Access</p> <p>Inland Port Greer</p> <ul style="list-style-type: none"> - 43 miles from the Heart of the County - 157,343 rail lifts in 2019 - 29.4% growth from 2018 <p>Port of Charleston</p> <ul style="list-style-type: none"> - 217 miles from the Heart of the County - 2.4 M TEUs handled in 2019 - 5.18% growth from 2018 	 <p>Highway Access</p> <p>Interstates</p> <ul style="list-style-type: none"> - 37 miles of I-85 and 8 interchanges <p>Highways</p> <ul style="list-style-type: none"> - US-29 - US-76 - US-178 - SC-24 - SC-81 	 <p>Rail Access</p> <p>Rail Providers</p> <ul style="list-style-type: none"> - 2 Major providers <ul style="list-style-type: none"> - CSX - Norfolk-Southern - 2 Short line providers <ul style="list-style-type: none"> - Greenville & Western - Pickens - Carolina Piedmont - All major MSA's in the US are accessible by rail within 3 to 6 days
---	---	--	---



UpstateSCAlliance

Upstate SC Alliance
 John Lummus, *President/CEO*
 864.283.2300
www.upstatescalliance.com



APPALACHIAN
 COUNCIL OF GOVERNMENTS
 Appalachian Council of Governments
 30 Century Circle, Greenville, SC 29607
 864.242.9733
www.scacog.org

Additional Resources

www.andersoncountysc.org/econ-dev
www.visitanderson.com

www.andersons chamber.com
www.upstatealliance.com

www.upstateforever.org
www.southcarolinaparks.com

Sources: ESRI Business Analyst (2020 and 2025 Estimates); US Census Bureau (2010 Census Data); US Bureau of Labor Statistics; Longitudinal Employer-Household Dynamics, US Census Bureau (2018); Commuting Patterns & Where do County Workers Live), Manufacturer's News, Appalachian Council of Governments, Cherokee County Development Board, and SC Department of Revenue and Taxation (Fiscal Year Retail Sales).

John Wright, Jr., CCIM

864.224.3503 • johnjr@mccoywright.com



McCOY WRIGHT
 COMMERCIAL REAL ESTATE